

**SOMERSET COUNTY COUNCIL**  
**THE COUNTY OF SOMERSET**  
**(HUNTWORTH ROUNDABOUT) (NORTH PETHERTON)**  
**(REVOCATION, RESTRICTED ROAD,**  
**AND 40MPH SPEED LIMIT) ORDER 2015**

SOMERSET COUNTY COUNCIL in exercise of its powers under Sections 81, 82 and 84 of the Road Traffic Regulation Act 1984 (hereinafter referred to as "the Act of 1984 of the Road Traffic Regulation Act 1984 (hereinafter referred to as "the Act of 1984") and of all other enabling powers, and after consultation with the Chief Officer of Police in accordance with Part III of Schedule 9 to the Act of 1984, hereby makes the following Order:-

1. This Order shall come into force on the 27<sup>th</sup> day of October 2015 and may be cited as "The County of Somerset (A38 Huntworth Roundabout) (North Petherton) (Revocation, Restricted Road and 40 mph Speed Limit) Order 2015".
2. No person shall drive any motor vehicle at a speed exceeding 30 miles per hour on the length of road specified in schedules 1 of this order as detailed below.
3. No person shall drive any motor vehicle at a speed exceeding 40 miles per hour on the length of road specified in schedule 2 of this order as detailed below.
4. Any existing speed limit orders relating to the lengths of road specified in schedule 1 above are hereby revoked.
5. The lengths of roads as specified in Schedule 1 to this Order shall become Restricted roads for the purpose of Section 81 of the Act.

GIVEN under the Common Seal of the Council this 23<sup>rd</sup> day of October 2015.

THE COMMON SEAL of the )  
 )  
COUNTY COUNCIL of SOMERSET )  
 )  
was hereunto affixed )  
 )  
in the presence of )



A handwritten signature in black ink, consisting of a stylized, wavy line.

Authorised Officer

No. in Register...*27366*.....

SCHEDULE 1  
RESTRICTED ROAD

A38 Bridgwater Road (Between Huntworth Roundabout and North Petherton)	from a point approximately 224 metres north east of its junction with Old Road, for a distance of approximately 900 metres in a north easterly direction.
---	---

SCHEDULE 2  
40 MPH SPEED LIMIT

A38 Taunton Road North Petherton	from Huntworth Roundabout to the existing 30 MPH terminal speed limit signs (located 88 metres south-east of Showground Roundabout), a distance of approximately 865 metres in a north-easterly, northerly then north-westerly direction.
-------------------------------------	---

A38 Bridgwater Road (Between Huntworth Roundabout and North Petherton)	from Huntworth Roundabout for a distance of approximately 55 metres in a south-westerly direction.
---	---

Huntworth Roundabout	the entire circulatory carriageway of Huntworth Roundabout, a distance of approximately 214 metres.
----------------------	--

A38, the road from Huntworth Interchange to Huntworth Roundabout	from a point 30 metres north west of Huntworth Interchange Roundabout for a distance of approximately 177 metres in a north-westerly direction.
--	---

Huntworth Business Park North Petherton	from a point 38 metres from Huntworth Roundabout for a distance of approximately 38 metres in an easterly direction.
--	--

Marsh Lane North Petherton	from its junction with the Lay-by off Kerland for a distance of approximately 348 metres in a north-easterly direction.
-------------------------------	---

Lay-by off Kerland North Petherton	For its entire length.
---------------------------------------	------------------------

Un-adopted road off Huntworth Roundabout	from Huntworth Roundabout for a distance of approximately 80 metres in a north-westerly direction.
---	---

SCHEDULE 3  
REVOCATION

Any existing speed limit orders relating to the lengths of road specified in schedule 1 above are hereby revoked.

**STATEMENT OF REASONS FOR PROPOSING TO MAKE THE ORDER**

For avoiding danger to persons or other traffic using the road or any other road or for preventing the likelihood of any such danger arising.

Plan to show proposed speed limit changes on the A38 Bridgwater Road, A38 Taunton Road, A38 interchange to Huntworth Roundabout, Huntworth Business Park, Layby off Kerland, Marsh Lane and un-adopted road (off Huntworth Roundabout)

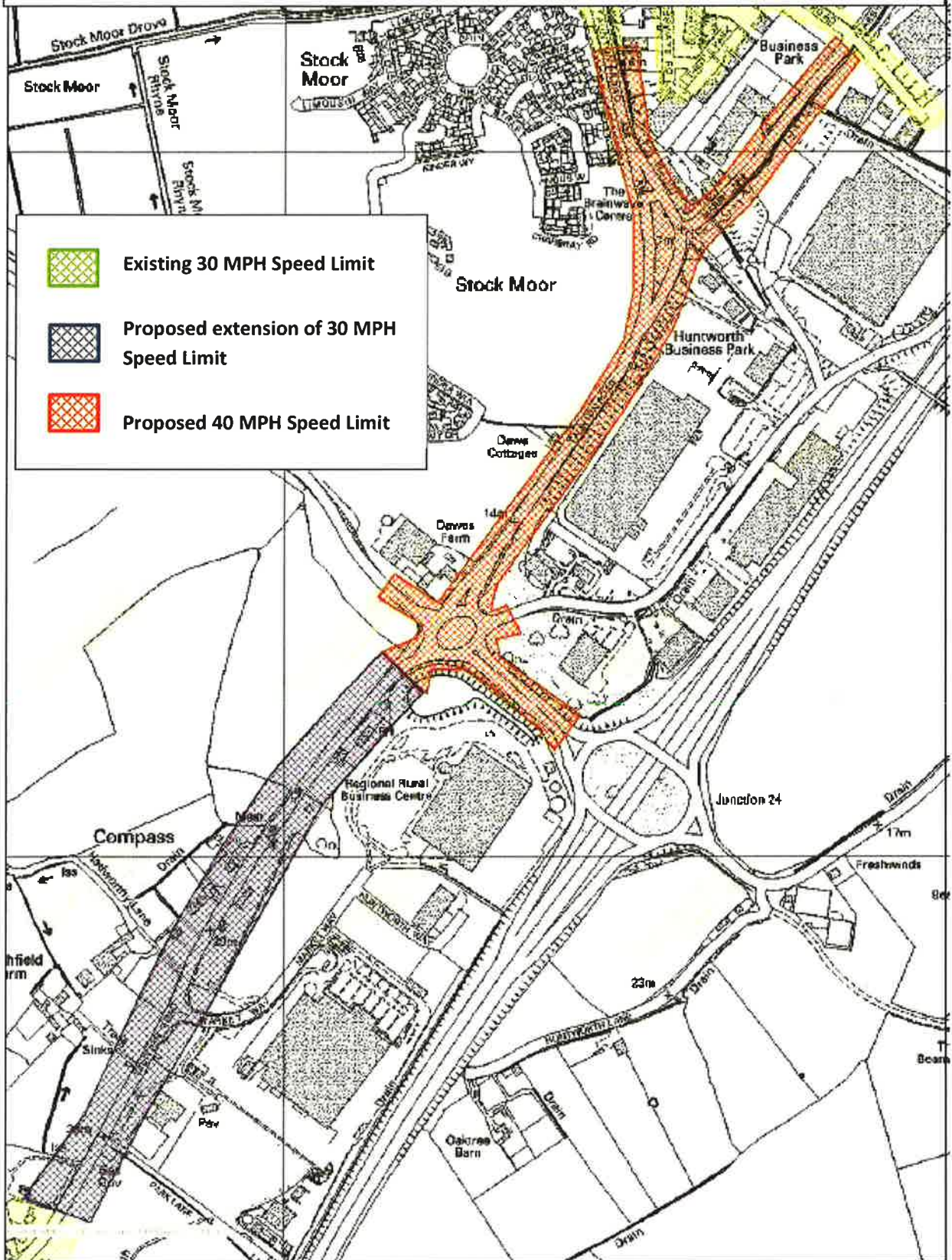

© Crown Copyright and Database Right (2014)  
Ordnance Survey 100038362

© SERC (2012) © GeoPerspectives

Date 2/9/2015

Scale 1/7417

Centre = 330273 E 134346 N

