

Northern Bridgwater Junction Improvements

One-way system

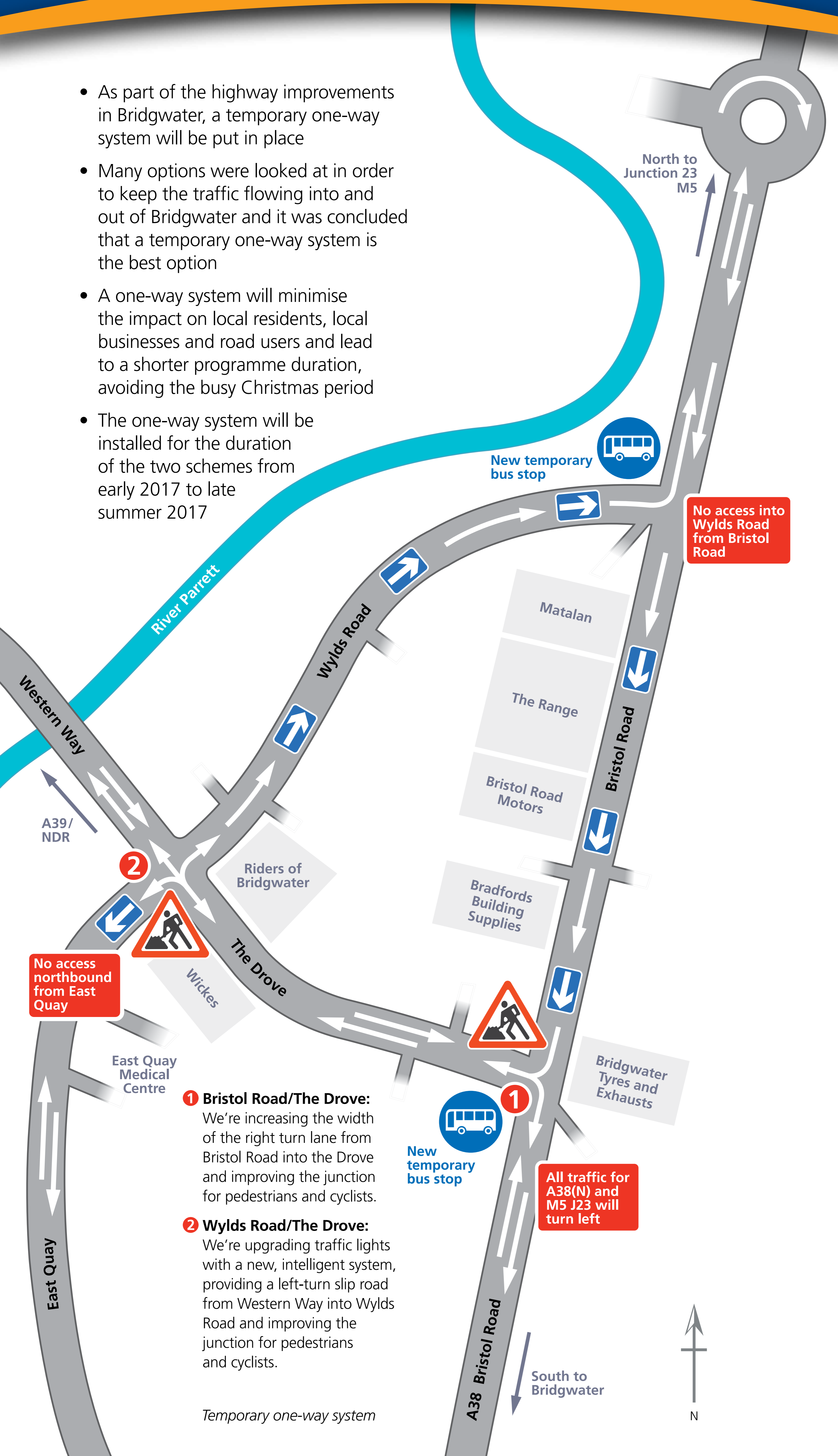

- As part of the highway improvements in Bridgwater, a temporary one-way system will be put in place
- Many options were looked at in order to keep the traffic flowing into and out of Bridgwater and it was concluded that a temporary one-way system is the best option
- A one-way system will minimise the impact on local residents, local businesses and road users and lead to a shorter programme duration, avoiding the busy Christmas period
- The one-way system will be installed for the duration of the two schemes from early 2017 to late summer 2017



1 Bristol Road/The Drove:
We're increasing the width of the right turn lane from Bristol Road into the Drove and improving the junction for pedestrians and cyclists.

2 Wylds Road/The Drove:
We're upgrading traffic lights with a new, intelligent system, providing a left-turn slip road from Western Way into Wylds Road and improving the junction for pedestrians and cyclists.

Temporary one-way system