

SOMERSET COUNTY COUNCIL
(A39 CANNINGTON BYPASS)
(PROHIBITION OF RIGHT TURNS)
ORDER 2018

SOMERSET COUNTY COUNCIL in exercise of its powers conveyed by the Road Traffic Regulation Act 1984, as amended, and of all other enabling powers hereby makes the following Order:-

1. This Order shall come into force on the 17th April 2018 and may be cited as the "Somerset County Council (A39 Cannington Bypass) (Prohibition of Right Turns) Order 2018"
2. No person except upon the direction of a police constable in uniform shall cause or permit any vehicle to make a right turn from the length of road in column 1 of Schedule 1 into the length of road in column 2.
3. The provisions of any other Order are hereby revoked but only in so far as they are affected by the restrictions imposed by this order.

GIVEN under the Common Seal of the Council this 13th day of April 2018

THE COMMON SEAL of the)
)
COUNTY COUNCIL of SOMERSET)
)
was hereunto affixed)
)
in the presence of



S Kerston

Authorised Officer

No. in Register 30617.....

SCHEDULE 1
Prohibition of Right Turns

Column 1

A39, Cannington Bypass
(westbound)

Column 2

From the unnamed road (park and ride site)
located at a point 530 metres West of the
roundabout junction with A39 Main Road

Column 1

From the unnamed road (park and ride
site) located at a point 530 metres
west of the roundabout junction with
A39 Main Road

Column 2

A39, Cannington Bypass
(westbound)

STATEMENT OF REASONS FOR PROPOSING TO MAKE THE ORDER

For avoiding danger to persons or other traffic using the road or any other road or for preventing the likelihood of any such danger arising.

LINE NO.	DATE	BY	REVISION	DESCRIPTION
0001	01/15/2024	JL	1	ISSUED FOR PERMITTING
0002	01/15/2024	JL	2	REVISED SIGN PLACEMENT
0003	01/15/2024	JL	3	REVISED SIGN PLACEMENT
0004	01/15/2024	JL	4	REVISED SIGN PLACEMENT
0005	01/15/2024	JL	5	REVISED SIGN PLACEMENT

NOTES

- All dimensions are in meters unless otherwise stated.
- All proposed sign posts & lighting columns along the A33 Carrington Southern Bypass shall be precast concrete type.
- When new road markings are to be added or existing carriageway, existing markings that conflict with the new markings shall be removed.
- Location of road signs and markings have been indicated on this drawing. The parties involved shall be agreed with the Overseeing Organisation or the relevant authority.
- All road markings to conform with the Traffic Signs Regulations and General Directions 2016.
- Road signs installed referring to PWS & Side-Set to be covered with a suitable material of varying agreed with the Overseeing Highway Authority and such time as required.

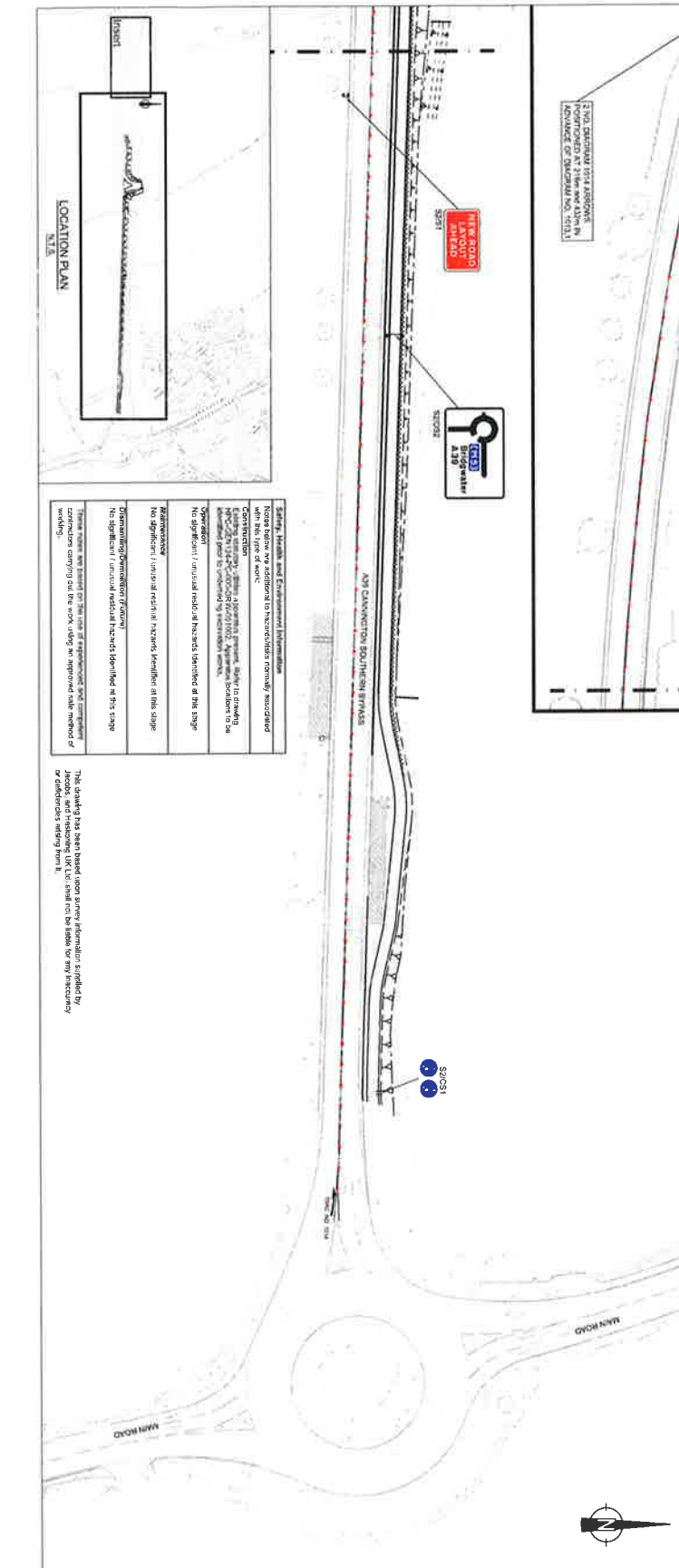
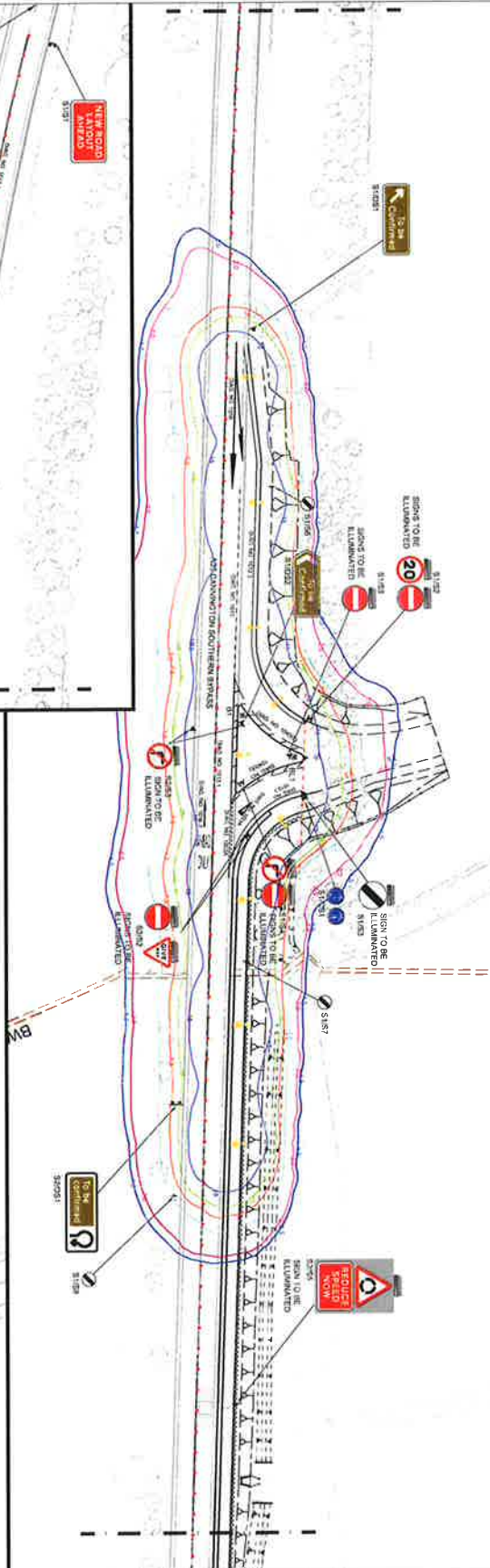

CLIENT INFORMATION

MNB GenCo
EDF ENERGY
ROYAL HASKINSONSHV

PROJECT INFORMATION

PROJECT NO: 24PC-000-DRW-20002
PROJECT NAME: HINKLEY POINT C ASSOCIATED DEVELOPMENTS CANNINGTON PARK & RIDE (ARTICLE 20) PROPOSED COTY & SIGNS

DESIGN INFORMATION

SCALE: 1:500
DATE: 2024

APPROVALS

DESIGNED BY: JL
CHECKED BY: JL
DRAWN BY: JL

DOCUMENT REFERENCE NO.

24PC-000-DRW-20002

REVISIONS

NO.	DESCRIPTION	DATE
001	ISSUED FOR PERMITTING	01/15/2024
002	REVISED SIGN PLACEMENT	01/15/2024
003	REVISED SIGN PLACEMENT	01/15/2024
004	REVISED SIGN PLACEMENT	01/15/2024
005	REVISED SIGN PLACEMENT	01/15/2024

This drawing has been based upon survey information supplied by the client and is not to be used for any other purpose without the written consent of the client. The client shall be liable for any inaccuracy or omissions arising from the survey information.